

JVC

4K PTZ Remote Camera (NDI®|HX)

KY-PZ400NW/NB

HD PTZ Remote Camera (NDI®|HX)

KY-PZ200NW/NB

HD PTZ Remote Camera

KY-PZ200W/B



KY-PZ400N

4K

SRT
SECURE
RELIABLE
TRANSPORT

**H.265/
HEVC**

NDI®|HX

A New Line of IP-Controlled PTZ Cameras provide Optimal Quality in Streaming and Remote Production over the Internet



KY-PZ200N/KY-PZ200

4K 1/2.5-inch CMOS Image Sensor

The KY-PZ400N is equipped with a 4K 1/2.5" CMOS image sensor with 8.51M effective pixels. The KY-PZ200N/PZ200 is equipped with an HD 1/2.8" CMOS image sensor with 2.07M effective pixels.



Powerful Optical Zoom: 12x KY-PZ400N **20x** KY-PZ200N/PZ200
Wide Horizontal Angle of View: 71° KY-PZ400N



A performer's technique can be captured clearly, even in a large hall.



KY-PZ400N
 f= 4.4mm – 52.8mm
 Approx. 26.4mm – 316.8mm
 (35mm equivalent)
 Digital zoom: 16x



KY-PZ200N/PZ200
 f= 4.4mm – 88.5mm
 Approx. 30.2mm – 606.9mm
 (35mm equivalent)
 Digital zoom: 16x

Remote Control of Multiple Cameras with RM-LP100 (optional)



By using the JVC RM-LP100 Remote Camera Controller, you can operate up to a hundred KY-PZ400/PZ200 Series cameras over the Internet. A variety of camera functions including PTZ, focus, iris, and menu settings can be controlled. PTZ Remote control capabilities are also made possible through the JVC KM-IP6000/IP4000 Live IP Production Suites or a variety of other options from vMix, OBS Studio and NewTek.

Quality Streaming with NDI® and SRT

For reliable, stable streaming, all models feature various QoS capabilities.



NDI®|HX is a high quality, low latency IP video transmission standard pioneered by NewTek.



SRT advanced streaming uses automatic repeat request (ARQ) and forward error correction (FEC) to prevent packet loss typical for internet connections. SRT also offers stream encryption for content protection.



On-Site IP Studio System

Installing KY-PZ400N cameras in the studio enables programs to be produced by a small number of people.

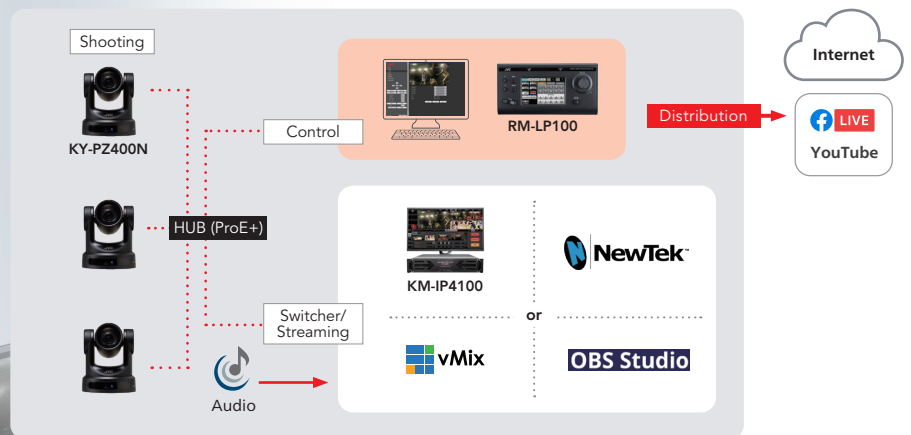

Item		Model	Description	Qty
1	Shooting	KY-PZ400N	4K PTZ Remote Camera	3
2		PC for KY-PZ400N		1
3	Control	RM-LP100	Remote Camera Controller	1
4		KM-IP6000/IP4000 Series	LIVE STREAMING PRODUCTION SUITE	
5	Switcher/Streaming	vMix		
6		OBS Studio		
7		Newtek		
8	Audio System			

H.264/H.265/Motion JPEG and Dual Streaming

In addition to H.264, a video codec widely used in PCs, smartphones, or tablets, H.265 is also supported. Moreover, the dual streaming capability enables workflows such as editing videos with low load using low-resolution substreams and simultaneously generating edited videos with high-resolution mainstreams.

2-Color Tally Useful for Studio Shooting

KY-PZ400N



A tally LED is available on top of the lens mount. It lights in either red or green depending on the mode, allowing you to easily check the program status or standby mode even while camera is panning.

UVC (USB Video Class) Support for Webcam Usage

KY-PZ200N/PZ200

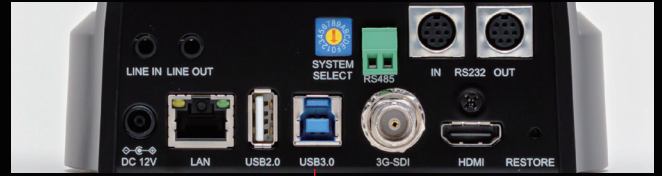

USB 3.0 with UVC Support

Photo shows KY-PZ200N/ PZ200.

Using an optional USB cable, you can connect the KY-PZ200N/ PZ200 directly to a PC and use it as a webcam. This allows for web conferencing and remote lectures with high quality, high magnification images.

Multi-Camera Synchronization with VITC and NTP

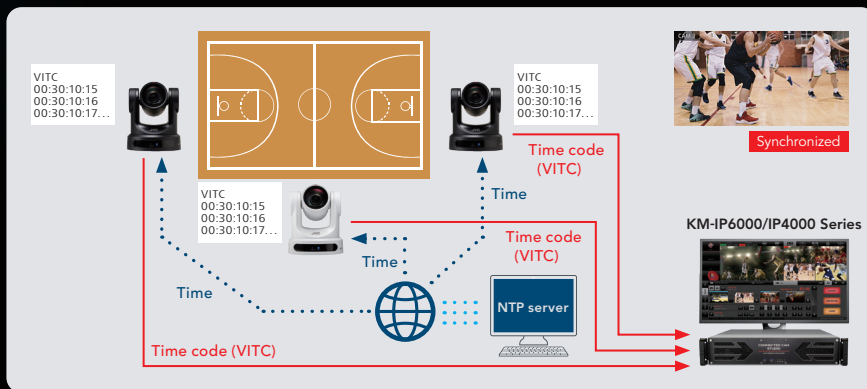

Multi-camera synchronization for live event productions is simply achieved with VITC (Vertical Interval Time Code) and NTP (Network Time Protocol). This feature is ideal for the mixing and streaming of concerts, shows and sporting events where image synchronization is critical.

REMI (Remote Production over the Internet)

With the KY-PZ400N series, you can take full advantage of the Internet for your live remote productions. Just bring your camera operators on location—no massive external devices requiring teams of people to operate are necessary. Connect via LAN to transmit broadcast quality video to a remote studio anywhere on the Internet.

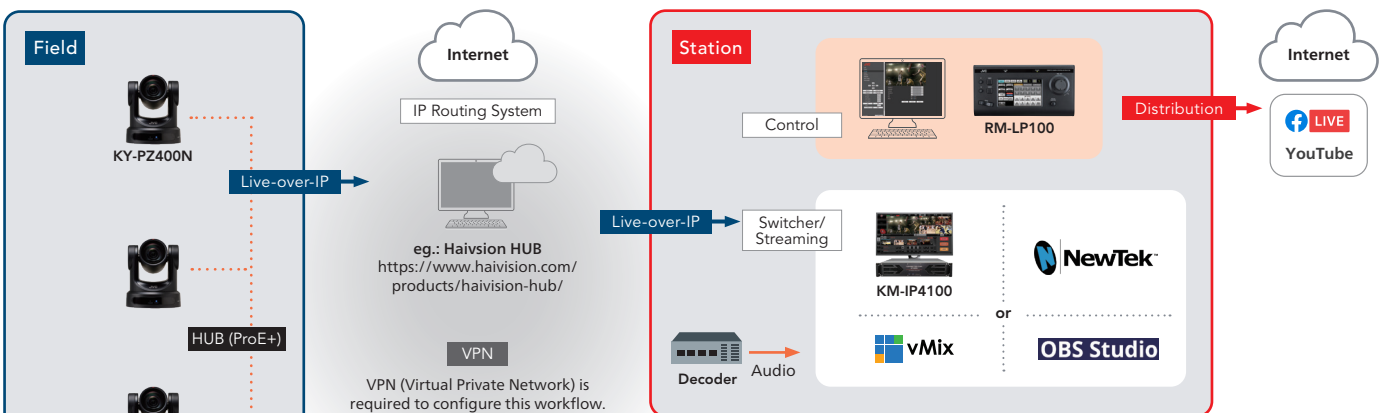

Item	Model	Description	Qty	
1	Shooting	KY-PZ400N	4K PTZ Remote Camera	3
2	Control	PC for KY-PZ400N		1
3		RM-LP100	Remote Camera Controller	1
4	Switcher/Streaming	KM-IP6000/IP4000 Series	LIVE STREAMING PRODUCTION SUITE	
5		vMix		
6		OBS Studio		
7		Newtek		
8	Audio System	Audio Encoder/Audio Decoder		

Specifications

		KY-PZ400N	KY-PZ200N	KY-PZ200
CAMERA	Sensor	1/2.5-inch Progressive CMOS, effective pixels: 8.51M	1/2.8-inch Progressive CMOS, effective pixels: 2.07M	←
	Lens	12x, f=4.4mm to 52.8mm, F1.8 to F2.6 35mm equivalent (approx.): 26.4mm to 316.8mm	20x, f=4.4mm to 88.5mm, F1.8 to F2.8 35mm equivalent (approx.): 30.2mm to 606.9mm	←
	Digital Zoom	16x		←
	Minimal Illumination	0.5lx @ F1.8, AGC ON		←
	Gain	0, 3, 6, 9, 12, 15, 18, 21, 24, 27, 30, 33, 36, 42, 45, 48dB		←
	Shutter	1/30s to 1/10000s		←
	White Balance	Auto, Indoor, Outdoor, One push, Manual		←
	Digital Noise Reduction	3DNR (Digital Noise Reduction) (OFF, 1 to 8, AUTO)		←
	Horizontal Angle of View	71° to 8.2°		←
	Vertical Angle of View	42.7° to 4.5°		←
	Horizontal Rotation Range	±170°		←
	Vertical Rotation Range	-30° to +90°		←
	Pan Speed Range	1.7° to 100°/s		←
	Tilt Speed Range	1.7° to 69.9°/s		←
Image	H/V flip, Image freeze, H/V auto inverting function		←	
Preset	Number of preset: 255, Preset accuracy: 0.1°		←	
NETWORK*	Video Compression	H.265/H.264/MJPEG		←
	Video Stream	Main Stream, Sub Stream		←
	Main Stream	3840x2160: 30p, 29.97p, 25p Resolution: 1920x1080, 1280x720, 1024x576, 720x480, 720x408, 640x480, 640x360 Frame Rate: 60p, 59.94p, 50p, 30p, 29.97p, 25p	Resolution: 1920x1080, 1280x720, 1024x576, 720x480, 720x408, 640x480, 640x360 Frame Rate: 60p, 59.94p, 50p, 30p, 29.97p, 25p	←
	Sub Stream	Resolution: 720x480, 720x408, 640x480, 640x360, 480x320, 320x240 Frame Rate: 60p, 59.94p, 50p, 30p, 29.97p, 25p		←
	Audio	Audio compression: AAC, Audio bit rate: 96K, 128K		←
	Supporting Protocols	Control: NDI@ HX, Standard, Pelco Streaming: RTSP/RTP, RTMP/RTMPS, SRT, NDI@ HX	Control: NDI@ HX, Standard, Pelco Streaming: RTSP/RTP, RTMP/RTMPS, SRT, NDI@ HX	Control: Standard, Pelco Streaming: RTSP/RTP, RTMP/RTMPS, SRT
SRT Mode	Listener, Caller, Rendezvous (Future update)		←	
INPUT/OUTPUT INTERFACES	HDMI Output Terminal	HDMI: Type A Video format: 3840x2160: 30p/29.97p/25p 1920x1080: 60p/59.94p/50p/30p/29.97p/25p 1920x1080: 60i/59.94i/50i 1280x720: 60p/59.94p/50p	HDMI: Type A Video format: 1920x1080: 60p/59.94p/50p/30p/29.97p/25p 1920x1080: 60i/59.94i/50i 1280x720: 60p/59.94p/50p	←
	3D-SDI Output Terminal	BNC type 720p/1080i/1080p: Embedded audio 3G-SDI: SMPTE ST424 compliant, HD-SDI: SMPTE ST292 compliant Video format: 1920x1080: 60p/59.94p/50p/30p/29.97p/25p 1920x1080: 60i/59.94i/50i 1280x720: 60p/59.94p/50p		←
	Network Interface	RJ45: 10BASE-T/100BASE-TX/1000BASE-T		←
	Audio Interface	Line In/Out: Φ3.5mm audio interface		←
	USB	USB2.0, A type (for maintenance)	USB2.0, A type (for maintenance) USB3.0, B type (for UVC)	←
	Communication Interface	RS232 IN: 8-pin mini DIN, Protocols: Standard/Pelco-D/Pelco-P RS232 OUT: 8-pin mini DIN, Protocols: Use only Standard protocol RS485: 2-pin Phoenix port Protocols: Standard/Pelco-D/Pelco-P		←
GENEAREL SPECIFICATIONS	LED	Tally: Red/Green x 1	—	←
	Input Voltage	Power: Blue x 1, Standby: Yellow-green x 1 DC 12V (AC Adapter), DC 37 to 57V (PoE)		←
	PoE Supply	802.3af standard		←
	Power Consumption	Approx. 0.78A (AC Adapter), Approx. 0.22A (PoE) (Default setting)		←
	Temperature	Operation: 0°C to 40°C, Storage: -20°C to 50°C		←
	Humidity	Operation: 30% to 80%, Storage: Under 85%		←
	Dimensions (W x H x D)	142mm x 165mm x 169mm		←
	Net Weight	Approx. 1.7kg	Approx. 1.5kg	←
	Menu Language	English, Chinese, Japanese, German, Spanish, Russian, French, Italian		←
	Accessories	 <ul style="list-style-type: none"> 1) AC Power Adapter 2) Power cable x 1 (Type A for U model), x 2 (Type C/BF for E model) 3) RS232 cable 4) IR remote control 5) User manual 6) Ceiling bracket 7) Logo sticker x 2 		

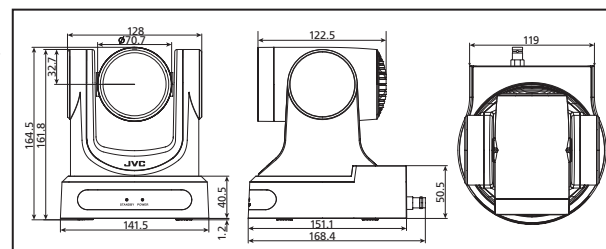

NDI® is a registered trademark of Vizrt Group.
Product and company names mentioned here are trademarks or registered trademarks of their respective owners. HDMI,
the HDMI logo and High-Definition Multimedia Interface are trademarks or registered trademarks of HDMI Licensing LLC.
QR Code is a registered trademark of Denso Wave Incorporated.

Simulated pictures. Values for weight and dimensions are approximate. E.&O.E. Design and specifications subject to change without notice. Copyright © 2021, JVCKENWOOD Corporation. All Rights Reserved.

DISTRIBUTED BY

For Instruction Manual

JVC Professional Video website



[http://www32.jvckenwood.com/
jvc/manual_e/index.asp](http://www32.jvckenwood.com/jvc/manual_e/index.asp)



USA
pro.jvc.com



Europe
eu.jvc.com/pro